



T2 UTILITY ENGINEERS  
 1420 WESTERN AVENUE  
 PITTSBURGH, PA 15233  
 724-776-4711

Date: 2/24/2023  
 Survey Crew: MH PL  
 File Date: 2/24/2023  
 Markout Crew: MH AH DS  
 T2 Project No.: PA034-007-02

STRUCTURE INVENTORY DATA

SURVEY

MARKOUT

Utility/Structure Type: Storm Manhole										
Elev's Rim: 787.55				Material: Precast						
Cover Size: 24"				SS ID #: D12						
<input type="checkbox"/> SQR <input type="checkbox"/> RECT <input type="checkbox"/> HEX <input checked="" type="checkbox"/> RND <input type="checkbox"/> OTHER				# PIPES	SIZE	TYPE	DROP F(RIM)	STRUCTURE #		
Datum's	Cadd #			A	1	24"	RCP	18.55'	TO D11	
Horiz: NAD 83	N. 398821.2350			B	1	18"	RCP	6.70'	FROM I8	
Vert: NAVD 88	E. 1376314.6240			C	1	8"	PVC	3.84'	FROM I6	
INVERTS				D	1	18"	RCP	7.82'	FROM D6	
Pipe	A	769.00	B	780.85	E	1	15"	N/A	5.44'	FROM I10
	C	783.71	D	779.73	F	1	18"	RCP	18.51'	FROM D3
	E	782.11	F	769.04	G	1	15"	RCP	6.77'	FROM I2
	G	780.78	H	779.77	H	1	6"	PVC	7.78'	FROM I4

Note: Buried manhole

BEP = Building Entry Point; EOI = End of Information; EOWL = End of Work Limit; N/A = Not Applicable

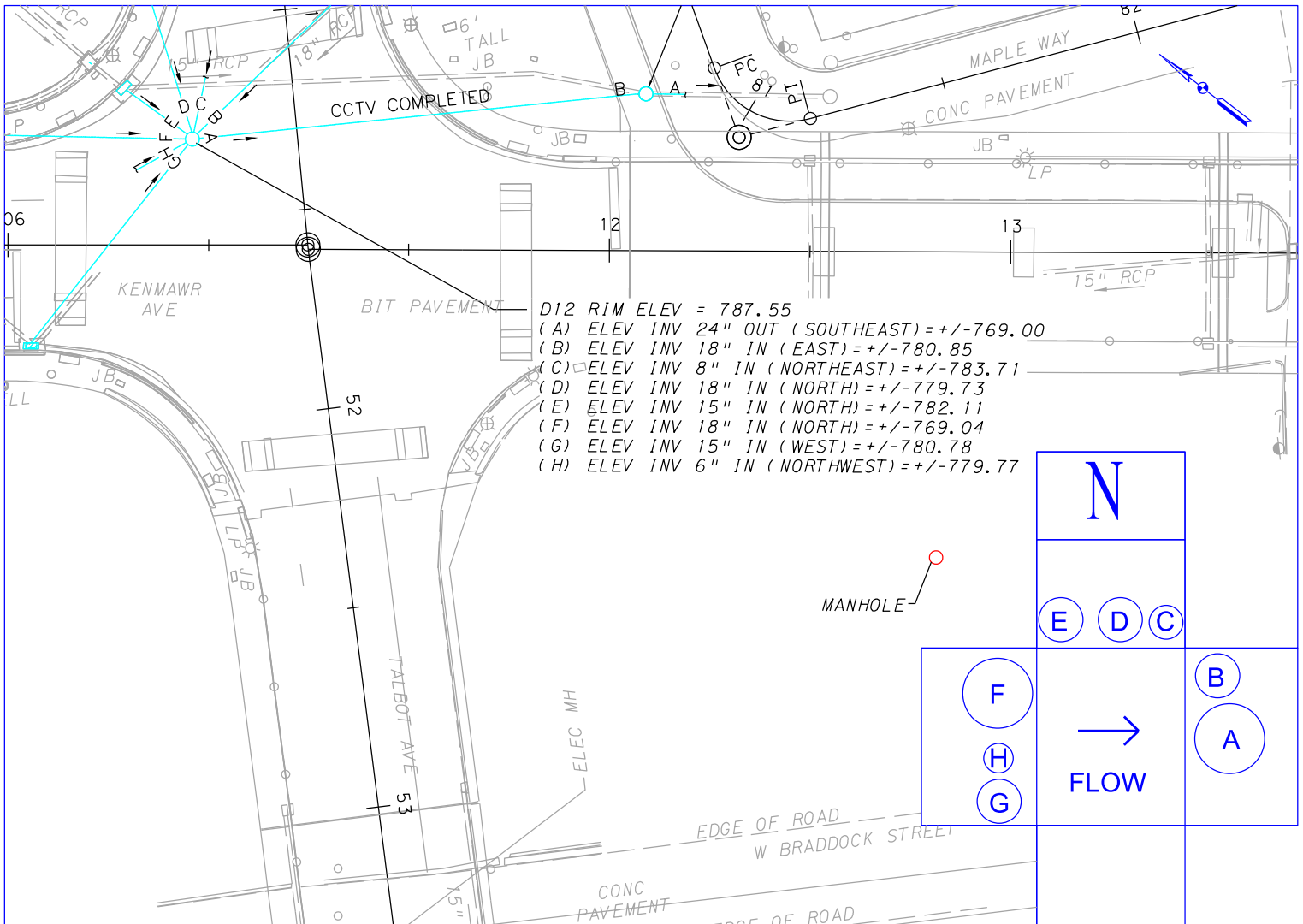

PREPARED BY: BJN    DATE 2/27/2023    QC BY: MFH    DATE 3/20/2023

# MANHOLE PHOTO REPORT

MANHOLE NO: D12 \_\_\_\_\_  
 DATE: 2/24/2023 \_\_\_\_\_  
 PROJECT NO: PA034-007-02 \_\_\_\_\_  
 CLIENT: WSP \_\_\_\_\_



PROJECT: KENMAWR AVE \_\_\_\_\_  
 CITY: PITTSBURGH \_\_\_\_\_  
 COUNTY: ALLEGHENY \_\_\_\_\_  
 LOCATION: ALONG KENMAWR AVE \_\_\_\_\_

**NORTH WALL (PIPES: B,C,D & E)**



**SOUTH WALL**



**EAST WALL (PIPE: A)**



**WEST WALL (PIPES: G,H, & F)**



**OVERVIEW**



**LOCATION**

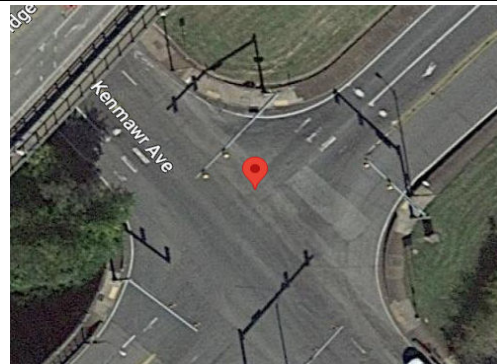

**UTILITY DESCRIPTION**

UTILITY TYPE: STORM

**DEPTH TO BOTTOM OF PIPE**

INVERT DROP (A):	18.55'
INVERT DROP (B):	6.70'
INVERT DROP (C):	3.84'
INVERT DROP (D):	7.82'
INVERT DROP (E):	5.44'
INVERT DROP (F):	18.51'
INVERT DROP (G):	6.77'
INVERT DROP (H):	7.78'

REMARKS: Buried manhole.

COMPLETED DATE: 2/27/2023

CHECKED DATE: 03/20/2023

REVISION DATE:

COMPLETED BY: BJN

CHECKED BY: MFH

UTILITIES SHOWN ON THESE PLANS AS DEPICTED IN THE LEGEND HAVE BEEN INVESTIGATED WITH ASPECTS OF: SUBSURFACE UTILITY ENGINEERING INDUSTRY STANDARDS, ASCE STANDARD 38-02. ALL OTHER INFORMATION SHOWN HAS BEEN PROVIDED TO T2UE BY OTHERS.

USE OF T2UE FOR SUBSURFACE UTILITY ENGINEERING (SUE) DOES NOT RELIEVE THE CLIENT, CONTRACTOR(S), PROPERTY OWNER(S), UTILITY OWNER(S) OR GOVERNMENTAL AGENCIES OF THE RESPONSIBILITY OF NOTIFYING PENNSYLVANIA ONE CALL SYSTEM PRIOR TO STARTING EXCAVATION. T2UE WILL NOT BE ASSUMED OR HELD RESPONSIBLE FOR DAMAGES TO UTILITIES CAUSED BY OTHERS.

T2UE DOES NOT GUARANTEE THAT ALL COMPONENTS OF UTILITY SYSTEMS, SUCH AS, ACTIVE, ABANDONED, OUT OF SERVICE STRUCTURES, AND REINFORCED REBAR CAN OR WILL BE DEPICTED ON THIS DRAWING, INCLUDING, BUT NOT LIMITED TO, UTILITIES LOCATED UNDERNEATH OTHER UTILITIES OR REINFORCED REBAR UNDER REINFORCED REBAR. THE POSSIBILITY EXISTS THAT SOME OR ALL TARGETS MAY BE LOCATED AT GREATER DEPTHS THAN THE MAXIMUM ACHIEVABLE INVESTIGATION DEPTHS OF ELECTROMAGNETIC LOCATING AND AIR VACUUM EXCAVATION EQUIPMENT, OR THAT SOME TARGETS MAY NOT HAVE ELECTRICAL PROPERTIES THAT ENABLE DETECTION OR CAN BE DIFFERENTIATED SUFFICIENTLY FROM SUBSURFACE SOILS. T2UE RECOMMENDS THAT FURTHER INVESTIGATIONS BE PERFORMED, INCLUDING, BUT NOT LIMITED TO, NON-DESTRUCTIVE EXPOSURE USING VACUUM EXCAVATION.

INFORMATION CONTAINED WITHIN THIS DRAWING SHALL NOT BE DISTRIBUTED TO OTHER PARTIES WITHOUT PRIOR WRITTEN CONSENT FROM T2UE.

INFORMATION CONTAINED WITHIN THIS DRAWING SHALL NOT BE ALTERED OR MODIFIED IN ANY WAY AND MAY ONLY BE USED FOR THE PURPOSE WHICH IT WAS INTENDED.

LEGEND	
	STORM
	END OF WORK LIMITS

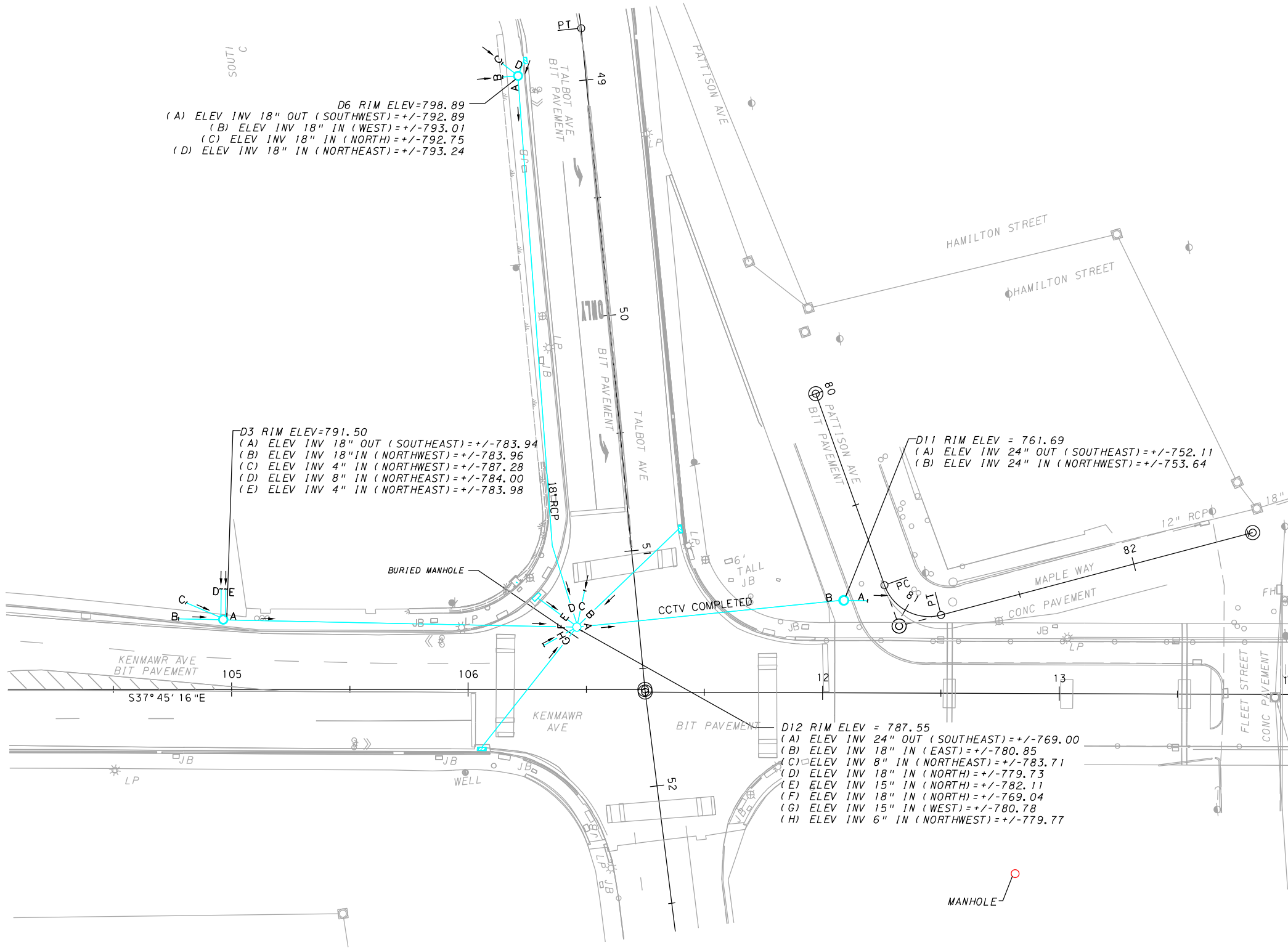

D6 RIM ELEV=798.89  
 (A) ELEV INV 18" OUT (SOUTHWEST)=+/-792.89  
 (B) ELEV INV 18" IN (WEST)=+/-793.01  
 (C) ELEV INV 18" IN (NORTH)=+/-792.75  
 (D) ELEV INV 18" IN (NORTHEAST)=+/-793.24

D3 RIM ELEV=791.50  
 (A) ELEV INV 18" OUT (SOUTHWEST)=+/-783.94  
 (B) ELEV INV 18" IN (NORTHWEST)=+/-783.96  
 (C) ELEV INV 4" IN (NORTHWEST)=+/-787.28  
 (D) ELEV INV 8" IN (NORTHEAST)=+/-784.00  
 (E) ELEV INV 4" IN (NORTHEAST)=+/-783.98

D11 RIM ELEV = 761.69  
 (A) ELEV INV 24" OUT (SOUTHWEST)=+/-752.11  
 (B) ELEV INV 24" IN (NORTHWEST)=+/-753.64

D12 RIM ELEV = 787.55  
 (A) ELEV INV 24" OUT (SOUTHWEST)=+/-769.00  
 (B) ELEV INV 18" IN (EAST)=+/-780.85  
 (C) ELEV INV 8" IN (NORTHEAST)=+/-783.71  
 (D) ELEV INV 18" IN (NORTH)=+/-779.73  
 (E) ELEV INV 15" IN (NORTH)=+/-782.11  
 (F) ELEV INV 18" IN (NORTH)=+/-769.04  
 (G) ELEV INV 15" IN (WEST)=+/-780.78  
 (H) ELEV INV 6" IN (NORTHWEST)=+/-779.77

Utility Quality Level "A" : Visually Verified Test Hole  
 Utility Quality Level "B" : Designating/Non Visually Verified Test Hole  
 Utility Quality Level "C" : Research with Survey  
 Utility Quality Level "D" : Records Research

All subsurface utilities shown at UTILITY quality level "B" unless otherwise noted.

S.U.E. INVESTIGATION OF UNDERGROUND UTILITIES

DRAFTED BY: BJN		TEST HOLE START DATE: 2/24/2023		T2 UTILITY ENGINEERS 1420 WESTERN AVENUE PITTSBURGH, PA 15233 724-776-4711	LOCATION: RANKIN BOROUGH	PROJECT NO: PA034-007-02
DRAFT DATE: 02/13/2023		TEST HOLE END DATE: 3/7/2023			COUNTY, STATE: ALLEGHENY, PENNSYLVANIA	DATE: 03/20/2023
DESIGNED BY: RJM		TEST HOLE CREW: MH AH PL DS			CLIENT: WSP	SHEET NO. 1 OF 1
REVIEWED BY: MFH						